

LifePlus®

Decking Screws 50x10*

Installation Instructions

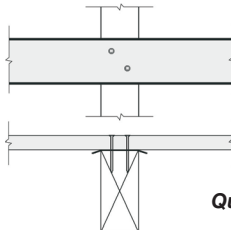

Quantity 500

Lifeplus screws are suitable for installing LifePlus decking as well as conventional 19 and 21mm hardwood and pine decking to hardwood and pine joists.

Screws should be installed in a staggered alignment with about 20mm (4 diameters) edge clearance

Hardwood joists predrill deck and joists 4mm to ensure that joists do not split
Pine joists predrilling is not necessary except at the end of the decking itself

The use of a dampcourse such as malthoid between the decking and the joists is strongly recommended.

Seal ends of decking with CN emulsion

We recommend that you seal your deck with Tanacoat



**Outdoor Structures
Australia**
outlasts and outperforms

Phone 1300 762 443

